

(see 85)

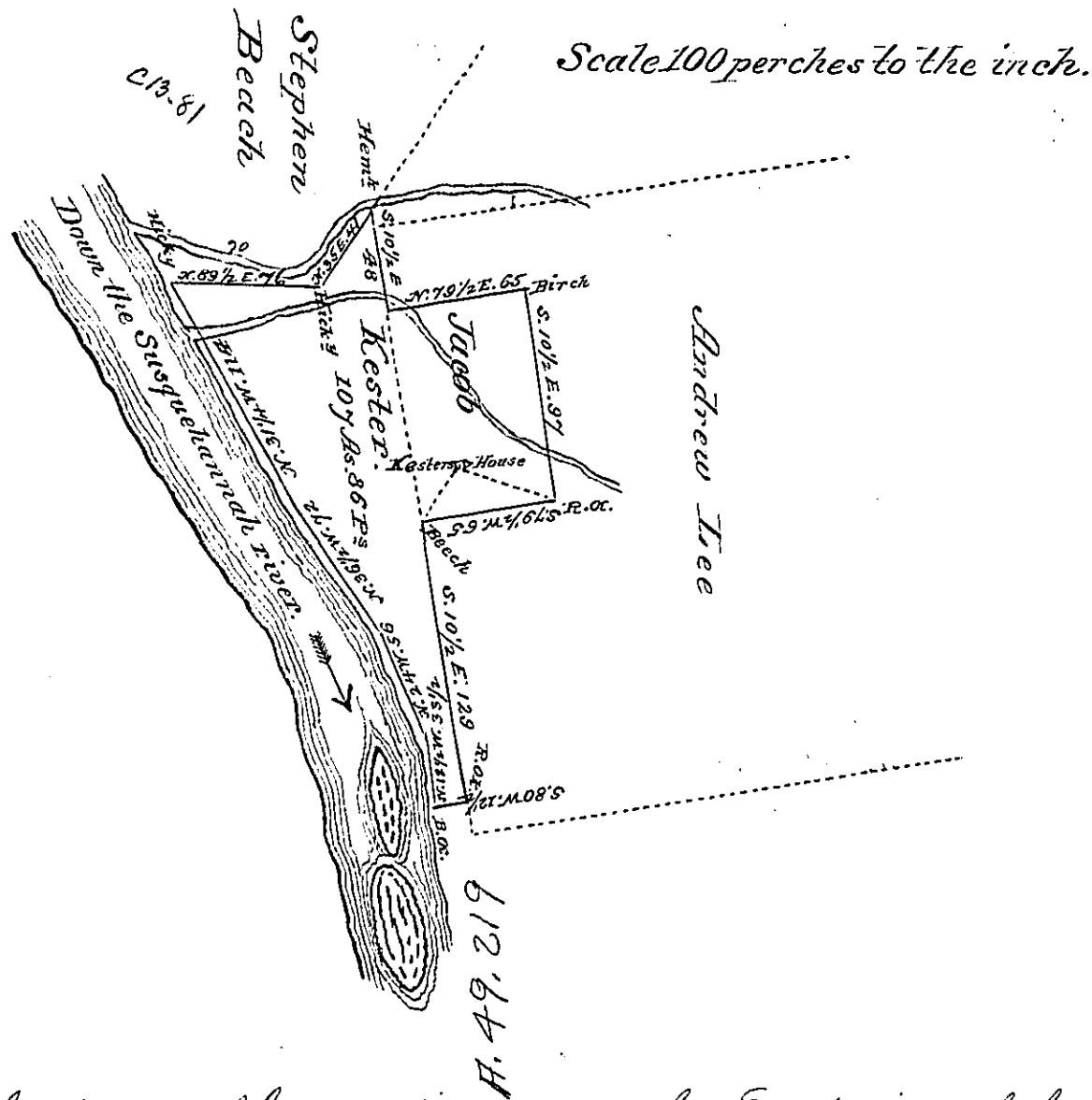

A Draft of a tract of land, situate on the East side of the North East branch of Susquehanna River, ^{in Nescopeck Town, Luzerne County} adjoining land of Stephen Beach, Andrew Lee, and the river, containing one hundred & seven Acres and eighty six perches of land the usual allowance of six per cent for roads &c Surveyed the 22^d day of April 1808 in pursuance of a Warrant dated the 16th day of October 1807 for Jacob Kister

Samuel Cochran Esq^r }
 Surveyor General } Geo. Naines D.S.

Thirty seven acres, and twenty eight perches, part of the above tract mentioned tract of land, interferes with a prior Warrant in the name of Andrew Lee. Altho, it appears that Kisters improvement was made before the date of Lee's Warrant, and it does not appear that the line of Lee's Survey, next to Kister was ever Marked on the Ground

Geo. Naines D.S.

IN TESTIMONY that the above is a copy of the original remaining on file in the Department of Internal Affairs of Pennsylvania, made conformably to an Act of Assembly approved the 16th day of February, 1833, I have hereunto set my Hand and caused the Seal of said Department to be affixed at Harrisburg, this

fifth day of November 1895.

James W. Latta
 Secretary of Internal Affairs.